

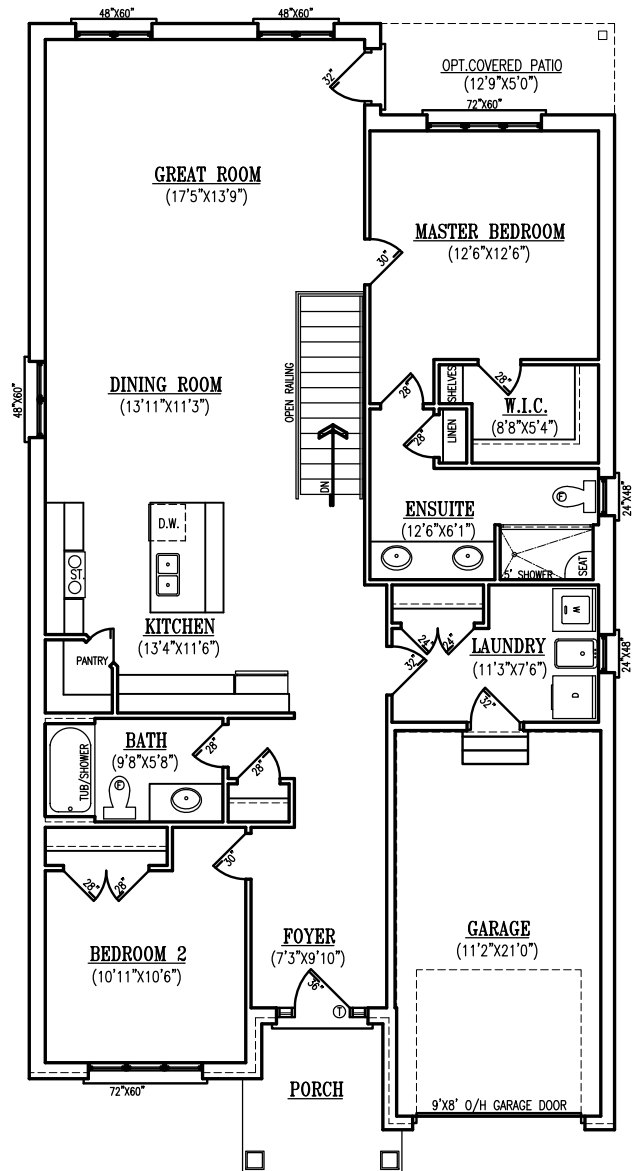

FRONT ELEVATION



FRONT ELEVATION-UPGRADED BRICK OPT.



MAIN FLOOR PLAN

1532 SQ. FT. (142.32 SQ.M.)

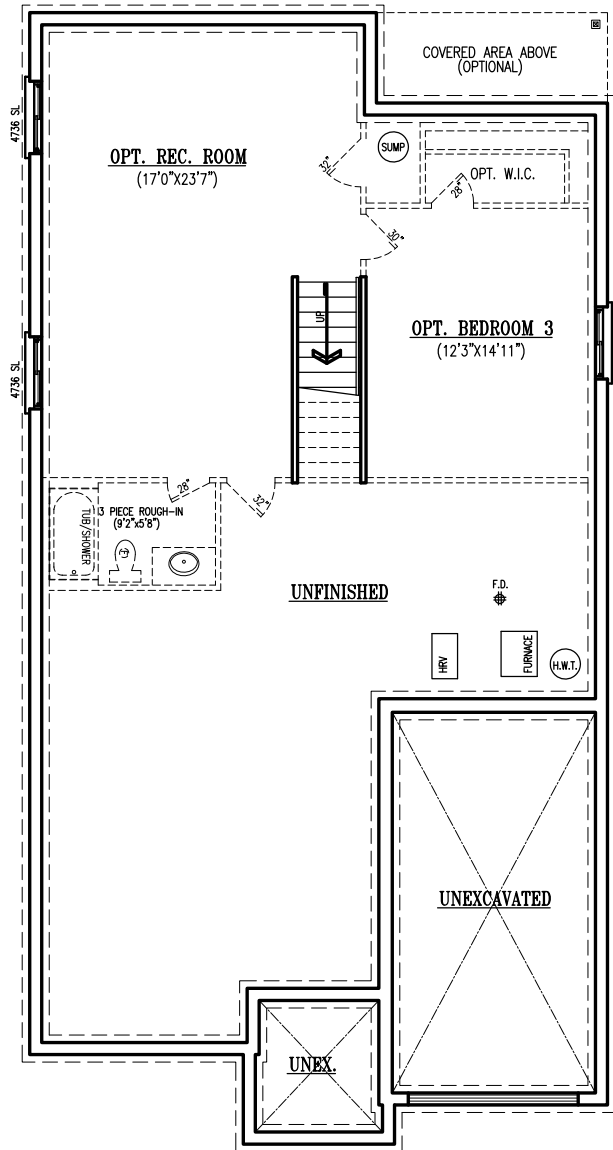

FOUNDATION PLAN

OPTIONAL FINISHED: 705 SQ. FT. (65.50 SQ.M.)

OVERALL SIZE - 32'-0" X 60'-6"

The MAPLE

TOTAL SQ.FT. = 1532 SQ.FT. (142.32 SQ.M.)